

DESCRIPTION	BY	DATE
ALTERATIONS		
ROGER LONG MARINE ARCHITECTURE, INC. Marine Trade Center, 2 Portland Fish Pier, Portland, Maine 04101		
115 FOOT RESEARCH VESSEL		
SIDE A-FRAME		
DESIGN NO. C-144		
DWG. NO. C-144-17, DATE 8/11/89, SCALE 1/2" = 1'-0"		
ALT. BY T.M. McCARTHY		

12/89

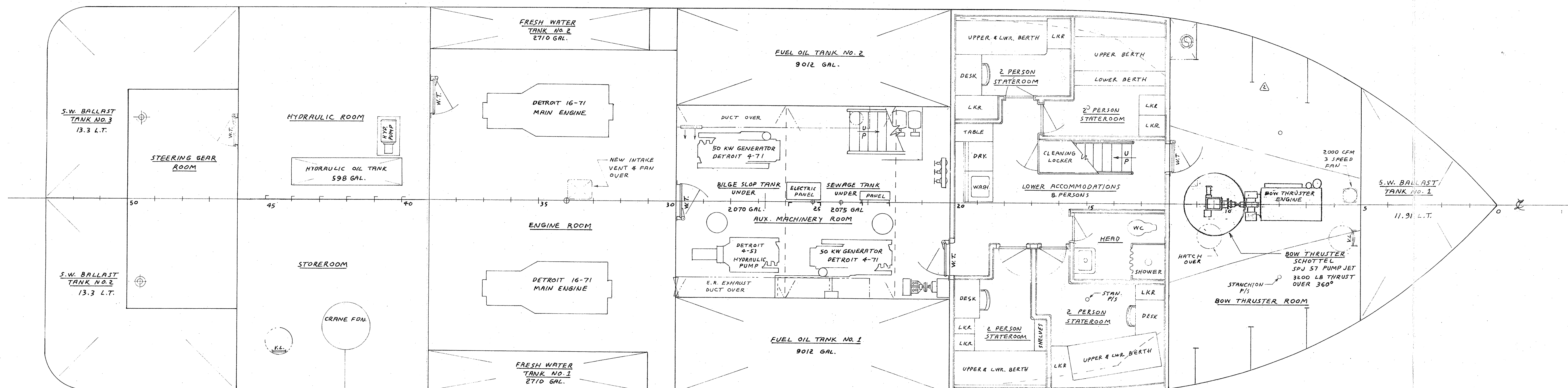

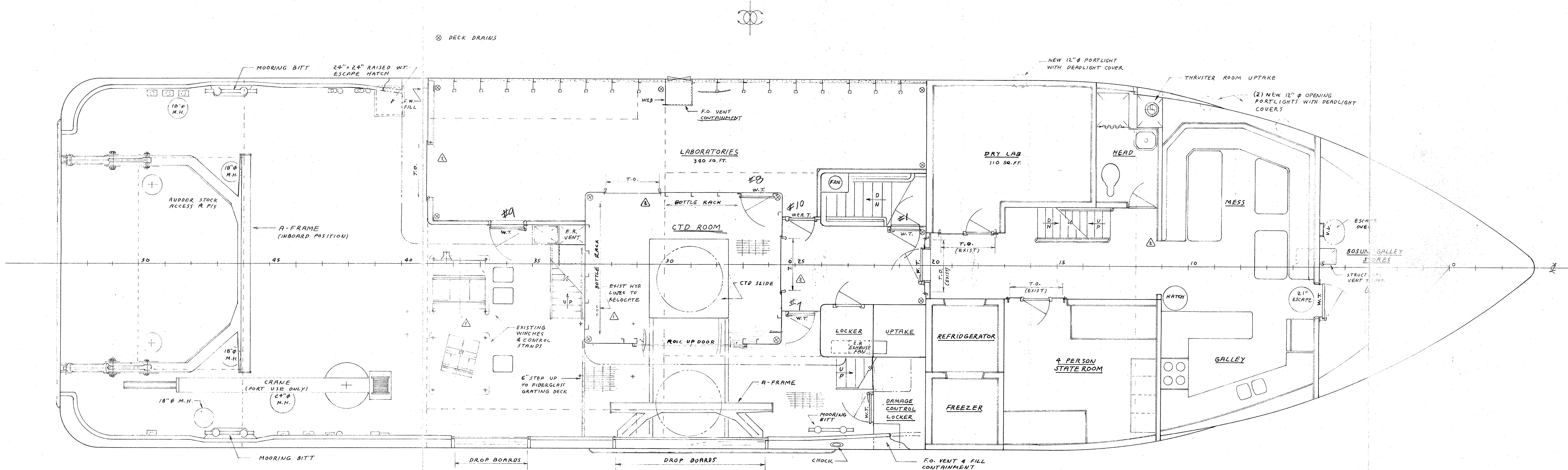

ALTERATIONS	DESCRIPTION	BY	DATE
1	THRUSTER ROOM VENT MOVED TOWARD OPERATIONS; ADDED SIDE WEBS ABOVE PAINT, 7, 9, & 11	R.L.	12-10-92
2	CTD ROOM BULKHEADS MOVED EXISTING WINCHES SHOWN	R.L.	10-21-92
3	GENERAL ARRANGEMENT MAIN DECK & HOLD		
4	DESIGN NO. C-144		
5	DWG. NO. C-144-3 DATE 9-1-92 SCALE 1/8"=1'-0"		
6	ALT. 2 BY <i>Roy Long</i>		
7	© Copyright 1992 By Roger Long Marine Architecture, Inc.		
8	Possession or receipt conveys no right to reproduce this document or use any of the information contained herein without specific written permission of the above.		

PRE-ENG-06th CONVENTION 11/97

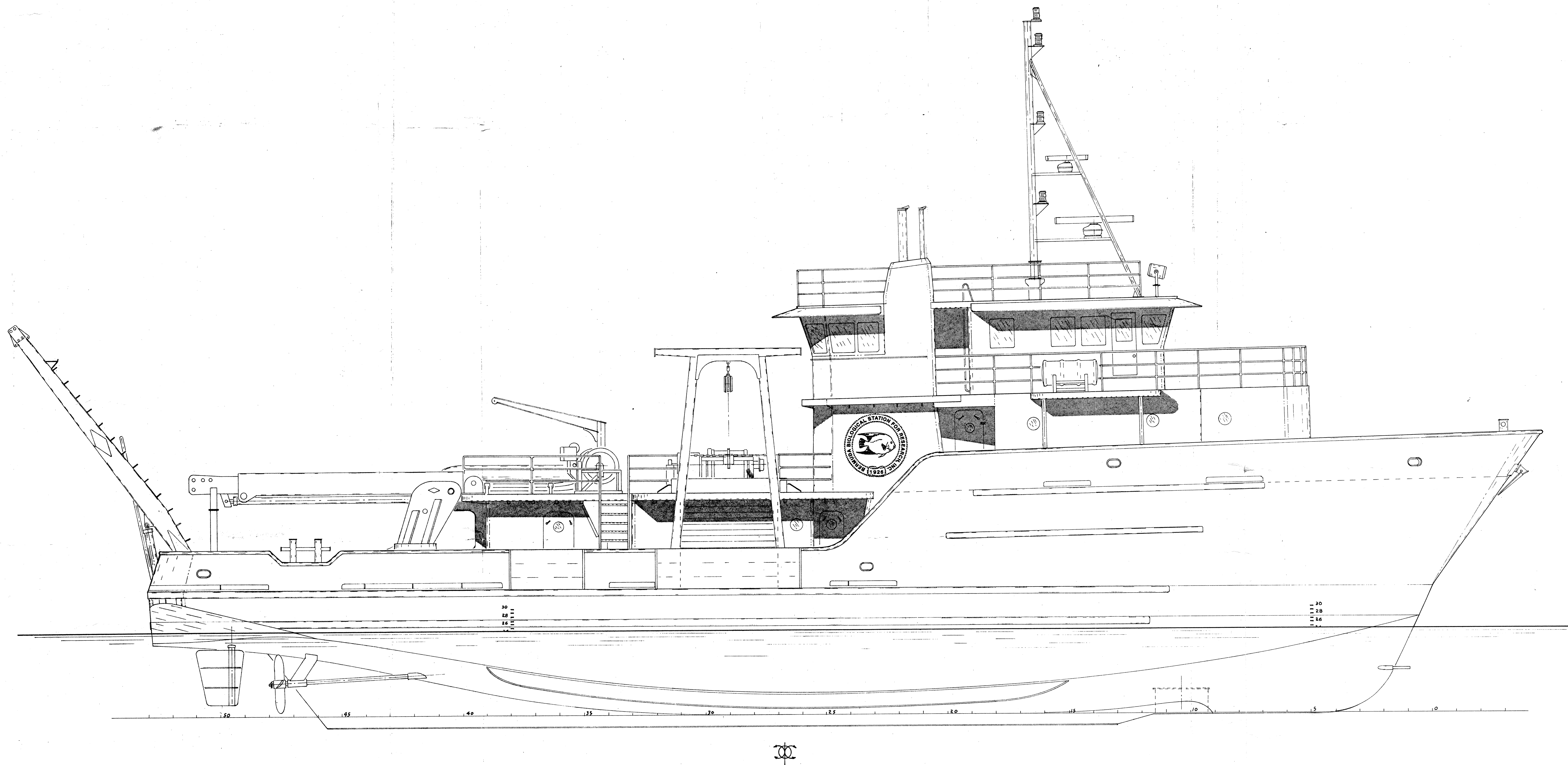

Δ	DESCRIPTION	BY	DATE
	ALTERATIONS		
	ROGER LONG		
	MARINE ARCHITECTURE, INC.		
	<u>R/V WEATHERBIRD II</u>		
	<u>OUTBOARD PROFILE</u>		
	DESIGN NO. C-144		
	DWG. NO. C-144-2 DATE 1-6-53 SCALE 1/4"=1'-0"		
	ALT. BY <u>Ros Long</u>		
	© Copyright 1953 By: Roger Long Marine Architecture, Inc.		
	Possession or receipt conveys no right to reproduce this document or use any of the information contained herein without specific written permission of the above.		